



MCL INCORPORATED

Item		Sheet No.	
Service		Item No.	
Tag No.		Q'ty	
Model No	MCL-M-DKOF015P		

DESCRIPTION

SERVICE CONDITION		FLUID :							
Condition	Flow Rate (m3/h)	Inlet Press (kgf/cm2 A)	Outlet Press	Inlet Temp. (°C)	Req'd Cv	Travel (%)	Velocity (ft/min)	Noise Level (dBA)	REMARK
Maximum									
Normal									
Minimum									

Specific Gravity		Viscosity (Pa.s)		Design P. (kgf/cm2 G)	
Molecular Weight		Vapor Press.(Mpa.a)		Design Temp.(°C)	
Pipe Line Spec.		Critical Press (Mpa.a)		Shut-Off P. (kgf/cm2 G)	
Inlet Pipe Size & Sch.		Outlet Pipe Size & Sch.			

VALVE BODY		ACUATOR		LIMIT SWITCH BOX	
Model No.	MCL-M-DKOF015P	Model No.		Maker	
Type	DIAPHRAGM	Type		Model No.	
Size	15A	Acting		EX-Proof	
Class Rating	PN10	Air Fail Position		TYPE	
End Connection	FLANGE F.F	Sol. V/V Energized to			
Bonnet Type		Handwheel & Mounting			
Material	Body	PVDF	Spring R.(kg /cm ² G)		
	Seat	PTFE	Supply (kgf/cm2G)		
	Seal	PTFE	Orientation		
	stem	stainless steel	Stroke		
Lubricator/Iso.Valve					
Lubricant					
Flange Face Finish	SMOOTH-FINISH				
Leakage Class	CLASS VI				

VALVE TRIM		SOLENOID VALVE	
Type		Maker	
Anty Cavity/Low Noise		Model No.	
Charcteristic		Power	
Port size(mm)		Output Signal	
Operating Angle(°)		EX-Proof	
Flow Direct		Electric Connection	
Balanced/Unbalanced			
Guide type		AIR SET(Filter+Regulator+ Gauge)	
Material	Disc	Maker	
	Seat	Model No.	
	Stem	Set. Press.(kgf/cm2 G)	
		Air Connection	
Leakage Class			

NOTE

MANUAL TEFLON BALL VALVE SPECIFICATION SHEET

0	R.J.OH	FOR APPROVAL	2021.06
REV.	BY	DESCRIPTION	DATE



MCL INCORPORATED

Item		Sheet No.	
Service		Item No.	
Tag No.		Q'ty	
Model No	MCL-M-DKOF020P		

DESCRIPTION

SERVICE CONDITION		FLUID :							
Condition	Flow Rate (m3/h)	Inlet Press (kgf/cm2 A)	Outlet Press	Inlet Temp. (°C)	Req'd Cv	Travel (%)	Velocity (ft/min)	Noise Level (dBA)	REMARK
Maximum									
Normal									
Minimum									

Specific Gravity		Viscosity (Pa.s)		Design P. (kgf/cm2 G)	
Molecular Weight		Vapor Press.(Mpa.a)		Design Temp.(°C)	
Pipe Line Spec.		Critical Press (Mpa.a)		Shut-Off P. (kgf/cm2 G)	
Inlet Pipe Size & Sch.		Outlet Pipe Size & Sch.			

VALVE BODY		ACUATOR		LIMIT SWITCH BOX	
Model No.	MCL-M-DKOF020P	Model No.		Maker	
Type	DIAPHRAGM	Type		Model No.	
Size	20A	Acting		EX-Proof	
Class Rating	PN10	Air Fail Position		TYPE	
End Connection	FLANGE F.F	Sol. V/V Energized to			
Bonnet Type		Handwheel & Mounting			
Material	Body	PVDF	Spring R.(kg /cm ² G)		
	Seat	PTFE	Supply (kgf/cm2G)		
	Seal	PTFE	Orientation		
	stem	stainless steel	Stroke		
Lubricator/Iso.Valve					
Lubricant					
Flange Face Finish	SMOOTH-FINISH				
Leakage Class	CLASS VI				

VALVE TRIM		SOLENOID VALVE	
Type		Maker	
Anty Cavity/Low Noise		Model No.	
Charcteristic		Power	
Port size(mm)		Output Signal	
Operating Angle(°)		EX-Proof	
Flow Direct		Electric Connection	
Balanced/Unbalanced			
Guide type		AIR SET(Filter+Regulator+ Gauge)	
Material	Disc	Maker	
	Seat	Model No.	
	Stem	Set. Press.(kgf/cm2 G)	
		Air Connection	
Leakage Class			

NOTE

**MANUAL TEFLON
BALL VALVE
SPECIFICATION SHEET**

0	R.J.OH	FOR APPROVAL	2021.06
REV.	BY	DESCRIPTION	DATE



MCL INCORPORATED

Item		Sheet No.	
Service		Item No.	
Tag No.		Q'ty	
Model No	MCL-M-DKOF025P		

DESCRIPTION

SERVICE CONDITION		FLUID :							
Condition	Flow Rate (m3/h)	Inlet Press (kgf/cm2 A)	Outlet Press	Inlet Temp. (°C)	Req'd Cv	Travel (%)	Velocity (ft/min)	Noise Level (dBA)	REMARK
Maximum									
Normal									
Minimum									

Specific Gravity		Viscosity (Pa.s)		Design P. (kgf/cm2 G)	
Molecular Weight		Vapor Press.(Mpa.a)		Design Temp.(°C)	
Pipe Line Spec.		Critical Press (Mpa.a)		Shut-Off P. (kgf/cm2 G)	
Inlet Pipe Size & Sch.		Outlet Pipe Size & Sch.			

VALVE BODY		ACUATOR		LIMIT SWITCH BOX	
Model No.	MCL-M-DKOF025P	Model No.		Maker	
Type	DIAPHRAGM	Type		Model No.	
Size	25A	Acting		EX-Proof	
Class Rating	PN10	Air Fail Position		TYPE	
End Connection	FLANGE F.F	Sol. V/V Energized to			
Bonnet Type		Handwheel & Mounting			
Material	Body	PVDF	Spring R.(kg /cm ² G)		
	Seat	PTFE	Supply (kgf/cm2G)		
	Seal	PTFE	Orientation		
	stem	stainless steel	Stroke		
Lubricator/Iso.Valve					
Lubricant					
Flange Face Finish	SMOOTH-FINISH				
Leakage Class	CLASS VI				

VALVE TRIM		SOLENOID VALVE	
Type		Maker	
Anty Cavity/Low Noise		Model No.	
Charcteristic		Power	
Port size(mm)		Output Signal	
Operating Angle(°)		EX-Proof	
Flow Direct		Electric Connection	
Balanced/Unbalanced			
Guide type		AIR SET(Filter+Regulator+ Gauge)	
Material	Disc	Maker	
	Seat	Model No.	
	Stem	Set. Press.(kgf/cm2 G)	
		Air Connection	
Leakage Class			

NOTE

**MANUAL TEFLON
BALL VALVE
SPECIFICATION SHEET**

0	R.J.OH	FOR APPROVAL	2021.06
REV.	BY	DESCRIPTION	DATE



MCL INCORPORATED

Item		Sheet No.	
Service		Item No.	
Tag No.		Q'ty	
Model No	MCL-M-DKOF032P		

DESCRIPTION

SERVICE CONDITION		FLUID :							
Condition	Flow Rate (m3/h)	Inlet Press (kgf/cm2 A)	Outlet Press	Inlet Temp. (°C)	Req'd Cv	Travel (%)	Velocity (ft/min)	Noise Level (dBA)	REMARK
Maximum									
Normal									
Minimum									

Specific Gravity		Viscosity (Pa.s)		Design P. (kgf/cm2 G)	
Molecular Weight		Vapor Press.(Mpa.a)		Design Temp.(°C)	
Pipe Line Spec.		Critical Press (Mpa.a)		Shut-Off P. (kgf/cm2 G)	
Inlet Pipe Size & Sch.		Outlet Pipe Size & Sch.			

VALVE BODY		ACUATOR		LIMIT SWITCH BOX	
Model No.	MCL-M-DKOF032P	Model No.		Maker	
Type	DIAPHRAGM	Type		Model No.	
Size	32A	Acting		EX-Proof	
Class Rating	PN10	Air Fail Position		TYPE	
End Connection	FLANGE F.F	Sol. V/V Energized to			
Bonnet Type		Handwheel & Mounting			
Material	Body	PVDF	Spring R.(kg /cm ² G)		
	Seat	PTFE	Supply (kgf/cm2G)		
	Seal	PTFE	Orientation		
	stem	stainless steel	Stroke		
Lubricator/Iso.Valve					
Lubricant					
Flange Face Finish	SMOOTH-FINISH				
Leakage Class	CLASS VI				

VALVE TRIM		SOLENOID VALVE	
Type		Maker	
Anty Cavity/Low Noise		Model No.	
Charcteristic		Power	
Port size(mm)		Output Signal	
Operating Angle(°)		EX-Proof	
Flow Direct		Electric Connection	
Balanced/Unbalanced			
Guide type		AIR SET(Filter+Regulator+ Gauge)	
Material	Disc	Maker	
	Seat	Model No.	
	Stem	Set. Press.(kgf/cm2 G)	
		Air Connection	
Leakage Class			

NOTE

MANUAL TEFLON BALL VALVE SPECIFICATION SHEET

0	R.J.OH	FOR APPROVAL	2021.06
REV.	BY	DESCRIPTION	DATE



MCL INCORPORATED

Item		Sheet No.	
Service		Item No.	
Tag No.		Q'ty	
Model No	MCL-M-DKOF040P		

DESCRIPTION

SERVICE CONDITION		FLUID :							
Condition	Flow Rate (m3/h)	Inlet Press (kgf/cm2 A)	Outlet Press	Inlet Temp. (°C)	Req'd Cv	Travel (%)	Velocity (ft/min)	Noise Level (dBA)	REMARK
Maximum									
Normal									
Minimum									

Specific Gravity		Viscosity (Pa.s)		Design P. (kgf/cm2 G)	
Molecular Weight		Vapor Press.(Mpa.a)		Design Temp.(°C)	
Pipe Line Spec.		Critical Press (Mpa.a)		Shut-Off P. (kgf/cm2 G)	
Inlet Pipe Size & Sch.		Outlet Pipe Size & Sch.			

VALVE BODY		ACUATOR		LIMIT SWITCH BOX	
Model No.	MCL-M-DKOF040P	Model No.		Maker	
Type	DIAPHRAGM	Type		Model No.	
Size	40A	Acting		EX-Proof	
Class Rating	PN10	Air Fail Position		TYPE	
End Connection	FLANGE F.F	Sol. V/V Energized to			
Bonnet Type		Handwheel & Mounting			
Material	Body	PVDF	Spring R.(kg /cm ² G)		
	Seat	PTFE	Supply (kgf/cm2G)		
	Seal	PTFE	Orientation		
	stem	stainless steel	Stroke		
Lubricator/Iso.Valve					
Lubricant					
Flange Face Finish	SMOOTH-FINISH				
Leakage Class	CLASS VI				

VALVE TRIM		SOLENOID VALVE	
Type		Maker	
Anty Cavity/Low Noise		Model No.	
Charcteristic		Power	
Port size(mm)		Output Signal	
Operating Angle(°)		EX-Proof	
Flow Direct		Electric Connection	
Balanced/Unbalanced			
Guide type		AIR SET(Filter+Regulator+ Gauge)	
Material	Disc	Maker	
	Seat	Model No.	
	Stem	Set. Press.(kgf/cm2 G)	
		Air Connection	
Leakage Class			

NOTE

MANUAL TEFLON BALL VALVE SPECIFICATION SHEET

0	R.J.OH	FOR APPROVAL	2021.06
REV.	BY	DESCRIPTION	DATE



MCL INCORPORATED

Item		Sheet No.	
Service		Item No.	
Tag No.		Q'ty	
Model No	MCL-M-DKOF050P		

DESCRIPTION

SERVICE CONDITION		FLUID :							
Condition	Flow Rate (m3/h)	Inlet Press (kgf/cm2 A)	Outlet Press	Inlet Temp. (°C)	Req'd Cv	Travel (%)	Velocity (ft/min)	Noise Level (dBA)	REMARK
Maximum									
Normal									
Minimum									

Specific Gravity		Viscosity (Pa.s)		Design P. (kgf/cm2 G)	
Molecular Weight		Vapor Press.(Mpa.a)		Design Temp.(°C)	
Pipe Line Spec.		Critical Press (Mpa.a)		Shut-Off P. (kgf/cm2 G)	
Inlet Pipe Size & Sch.		Outlet Pipe Size & Sch.			

VALVE BODY		ACUATOR		LIMIT SWITCH BOX	
Model No.	MCL-M-DKOF050P	Model No.		Maker	
Type	DIAPHRAGM	Type		Model No.	
Size	50A	Acting		EX-Proof	
Class Rating	PN10	Air Fail Position		TYPE	
End Connection	FLANGE F.F	Sol. V/V Energized to			
Bonnet Type		Handwheel & Mounting			
Material	Body	PVDF	Spring R.(kg /cm ² G)		
	Seat	PTFE	Supply (kgf/cm2G)		
	Seal	PTFE	Orientation		
	stem	stainless steel	Stroke		
Lubricator/Iso.Valve					
Lubricant					
Flange Face Finish	SMOOTH-FINISH				
Leakage Class	CLASS VI				

VALVE TRIM		SOLENOID VALVE	
Type		Maker	
Anty Cavity/Low Noise		Model No.	
Charcteristic		Power	
Port size(mm)		Output Signal	
Operating Angle(°)		EX-Proof	
Flow Direct		Electric Connection	
Balanced/Unbalanced			
Guide type		AIR SET(Filter+Regulator+ Gauge)	
Material	Disc	Maker	
	Seat	Model No.	
	Stem	Set. Press.(kgf/cm2 G)	
		Air Connection	
Leakage Class			

NOTE

MANUAL TEFLON BALL VALVE SPECIFICATION SHEET

0	R.J.OH	FOR APPROVAL	2021.06
REV.	BY	DESCRIPTION	DATE



MCL INCORPORATED

Item		Sheet No.	
Service		Item No.	
Tag No.		Q'ty	
Model No	MCL-M-DKOF065P		

DESCRIPTION

SERVICE CONDITION		FLUID :							
Condition	Flow Rate (m3/h)	Inlet Press (kgf/cm2 A)	Outlet Press	Inlet Temp. (°C)	Req'd Cv	Travel (%)	Velocity (ft/min)	Noise Level (dBA)	REMARK
Maximum									
Normal									
Minimum									

Specific Gravity		Viscosity (Pa.s)		Design P. (kgf/cm2 G)	
Molecular Weight		Vapor Press.(Mpa.a)		Design Temp.(°C)	
Pipe Line Spec.		Critical Press (Mpa.a)		Shut-Off P. (kgf/cm2 G)	
Inlet Pipe Size & Sch.		Outlet Pipe Size & Sch.			

VALVE BODY		ACUATOR		LIMIT SWITCH BOX	
Model No.	MCL-M-DKOF065P	Model No.		Maker	
Type	DIAPHRAGM	Type		Model No.	
Size	65A	Acting		EX-Proof	
Class Rating	PN10	Air Fail Position		TYPE	
End Connection	FLANGE F.F	Sol. V/V Energized to			
Bonnet Type		Handwheel & Mounting			
Material	Body	PVDF	Spring R.(kg /cm ² G)		
	Seat	PTFE	Supply (kgf/cm2G)		
	Seal	PTFE	Orientation		
	stem	stainless steel	Stroke		
Lubricator/Iso.Valve					
Lubricant					
Flange Face Finish	SMOOTH-FINISH				
Leakage Class	CLASS VI				

VALVE TRIM		SOLENOID VALVE	
Type		Maker	
Anty Cavity/Low Noise		Model No.	
Charcteristic		Power	
Port size(mm)		Output Signal	
Operating Angle(°)		EX-Proof	
Flow Direct		Electric Connection	
Balanced/Unbalanced			
Guide type		AIR SET(Filter+Regulator+ Gauge)	
Material	Disc	Maker	
	Seat	Model No.	
	Stem	Set. Press.(kgf/cm2 G)	
		Air Connection	
Leakage Class			

NOTE

**MANUAL TEFLON
BALL VALVE
SPECIFICATION SHEET**

0	R.J.OH	FOR APPROVAL	2021.06
REV.	BY	DESCRIPTION	DATE

	A		B			C			D		E	F	G	H
	d	DN	PN	B	B1	f	F	H	H1	Sp	U	g	PTFE Code	
	20	15	10	102	25	14	65	130	80	13.5	4		MCL-M-DKOF015P	20
1	25	20	10	105	30	14	75	150	80	13.5	4		MCL-M-DKOF020P	19
	32	25	10	114	33	14	85	160	80	14	4		MCL-M-DKOF025P	18
	40	32	10	119	35	18	100	180	80	14	4		MCL-M-DKOF032P	17
	50	40	10	147	46	18	110	200	120	16	4		MCL-M-DKOF040P	16
	63	50	10	172	55	18	125	230	120	16	4		MCL-M-DKOF050P	15
2	75	65	10	225	20	18	145	290	120	21	4		MCL-M-DKOF065P	14

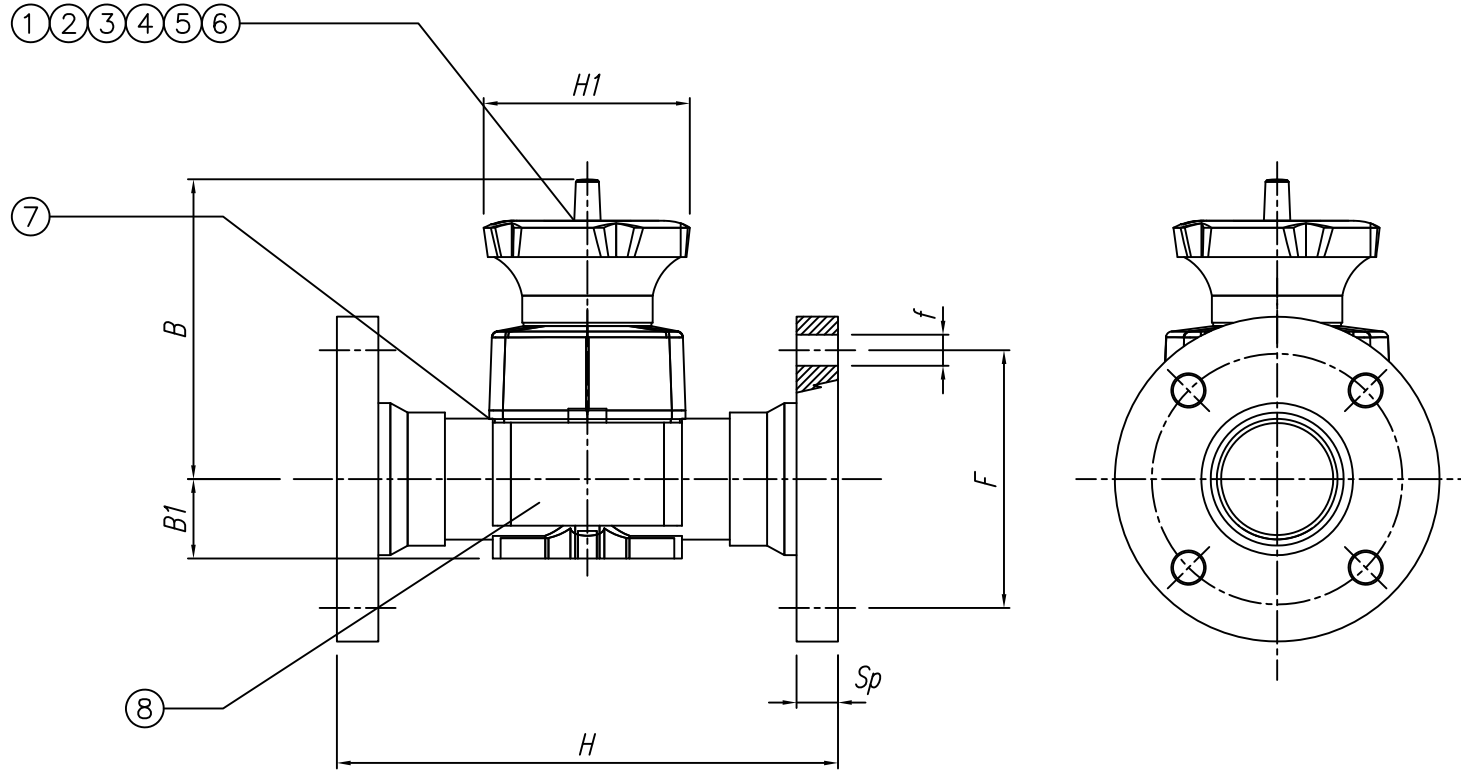

13			
12			
11			
10			
9			
8	Valve body	1*	PVDF
7	Diaphragm seal & seat	1*	PTFE
6	Compressor	1	IXEF
5	Threaded stem Indicator	1	Stainless steel
4	Operating mechanism	1	PP-GR
3	plate	1	PP-GR
2	Customisation plate	1	PVC-U
1	Transparent protection cop	1*	PVC
NO	Part Name	Q'TY	Mat'L / Model

Ult Client:
-

Customer:
-

Project:
-

Rev.No.	Date	Description	Design	Chk'D	App'D	SH. NO	Title	DUAL BLACK 2-Way Ball Valve		
5							Model Code	MCL - M - DKOF		
4							size	-	View	
3							Rating	-	Scale	N/S
2							Dwg no.	-		
1										



<http://www.j-mcl.com/>

DRAW	CHECKED	APPRVED
Sim J.W. 22. 01. 25	Oh J.r. 22. 01. 25	Oh J.r. 22. 01. 25