



MCL INCORPORATED

Item		Sheet No.	
Service		Item No.	
Tag No.		Q'ty	
Model No.	MHF-100A-125S-SR		

DESCRIPTION

SERVICE CONDITION		FLUID :							
Condition	Flow Q'ty (m3/h)	Inlet Press (kgf/cm2 A)	Press Drop (kgf/cm ²)	Inlet Temp. (°C)	Req'd Cv	Travel (%)	Velocity (ft/min)	Noise Level (dBA)	REMARK
Maximum									
Normal									
Minimum									

Specific Gravity		Viscosity (Pa.s)		Design P. (kgf/cm2 G)	
Molecular Weight		Vapor Press.(Mpa.a)		Design Temp.(°C)	
Pipe Line Spec.		Critical Press (Mpa.a)		Shut-Off P. (kgf/cm2 G)	
Inlet Pipe Size & Sch.		Outlet Pipe Size & Sch.		Rated Cv	

VALVE BODY		ACTUATOR			
Model No.	MHF-100A-125S-SR	Model No.	MA-125S		
Type	BUTTERFLY	Type	CYLINDER		
Size	100A	Acting	SINGLE		
Class Rating	JIS 10K	Air Fail Position	CLOSE (CSD)		
End Connection	WAFER	Sol. V/V Energized to			
Bonnet Type	STD	Handwheel & Mounting	N/A		
Material	Body	SCS13	Spring R.(kg /cm2G)	1.5 ~ 2.5	
	Bonnet		Supply (kgf/cm2G)	5	
	Packing		Orientation	HORIZONTAL	
	Gasket		Stroke	0~90 DEG	
Lubricator/Iso.Valve					
Lubricant					
Flange Face Finish					

VALVE TRIM		POSITIONER			
Type	HI PERFORMANCE	Maker	TISSIN		
Anty Cavity/Low Noise	NA	Model No.	TS600 / Rotary		
Charcteristic	MODI-EQUAL %	Input Signal.	4-20mA		
Port size(mm)	100A	Output Signal	N/A		
Operating Angle(°)	90 Deg	EX-Proof	ExdIICT6		
Flow Direct	FORWARD	Electric Connection	NPT 1/2		
Balanced/Unbalanced					
Guide type	TOP & BOTTOM	AIR SET(Filter+Regulator+Gauge)			
Material	Disc	SUS304	Maker	POWER GENEX	
	Seat	RTFE	Model No.	FR10	
	Stem	SUS304	Set. Press.(kgf/cm2 G)	5	
			Air Connection	PT 1/4	
Leakage Class	CLASS VI				
Cv	380				

NOTE

PNEUMATIC BUTTERFLY VALVE SPECIFICATION SHEET				
	0	R.J.OH	FOR APPROVAL	2020.03
	REV.	BY	DESCRIPTION	DATE

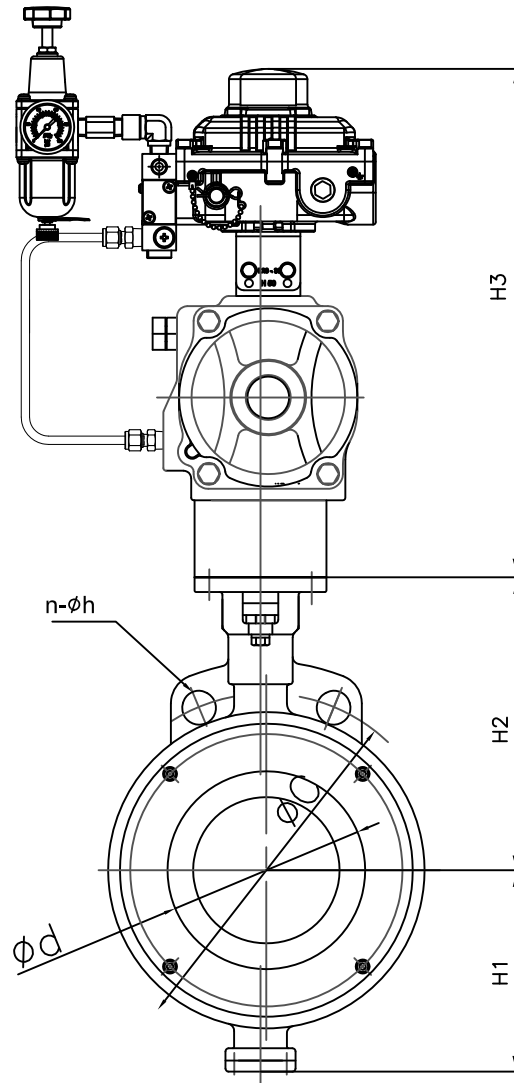
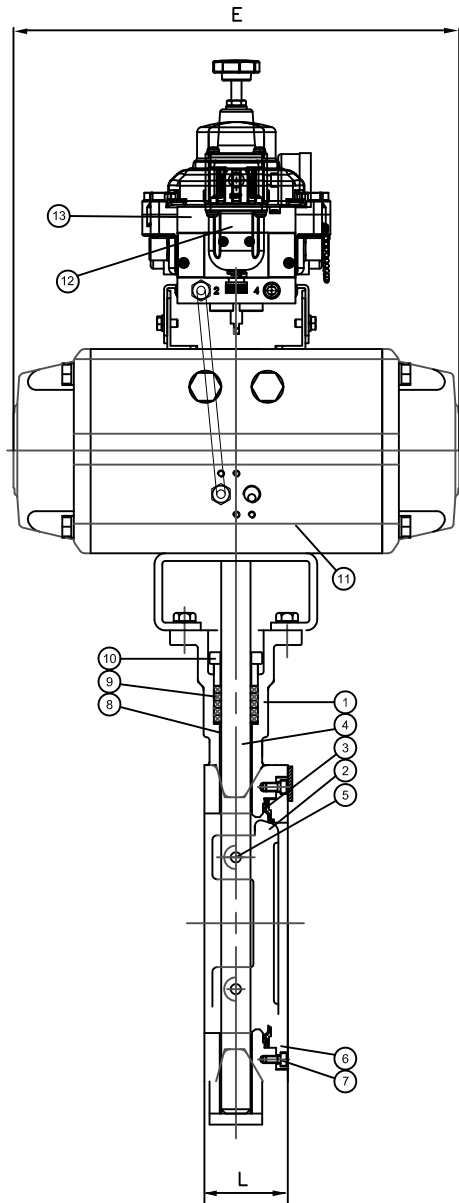

P.NO.	PART NAME	MATERIAL	Q'TY	REMARK
1	BODY	SCS13	1	
2	DISC	SUS304	1	
3	SEAT	RTFE	1	
4	STEM	SUS304	1	
5	DISC PIN	SUS304	2	
6	RETAINER	SUS304	1	
7	RETAINER BOLT	SUS304	4-6	
8	STEM B/R	METALOPLAST	1	
9	PACKING	TEFLON	1set	
10	PACKING GLAND	SUS304	1	
11	CYLINDER	ASS'Y	1	
12	Air Filter Regulator	ASS'Y	1	
13	Positioner	ASS'Y	1	

DIMENSIONS									MODEL NO
NOMINAL DIAMETER	φd	L	FLANGE		REFERENCE / APPROX.				
			φC	n-φh	H1	H2	H3	E	
50(2")	49	43	120	8-φ19	84	123	350	280	MHF-50A-88S-SR
65(1½")	62	46	140	8-φ19	93	144	350	280	MHF-65A-88S-SR
80(3")	73	48	160	8-φ23	105	154	375	280	MHF-80A-115S-SR
100(4")	95	54	185	8-φ23	118	174	385	280	MHF-100A-125S-SR
125(5")	120	56	225	8-φ25	137	195	410	280	MHF-125A-145S-SR
150(6")	141	57	260	12-φ25	156	216	410	280	MHF-150A-145S-SR
200(8")	194	64	305	12-φ25	185	250	420	380	MHF-200A-210S-SR
250(10")	239	72	380	12-φ27	233	285	420	380	MHF-250A-212S-SR

FLANGE RATING : JIS 10K

* NOTES

- Design Standard : API 609 Cat'-B
- Face to Face Dimension : API 609 Category B

TEST SPECIFICATION-API 598					
Test Fluid	BODY		SEAT		Design Pressure
	Water		Water		
Test Pressure	Design Pressure*1.5 Time		Design Pressure*1.1 Time		20 BAR
	30 BAR		22 BAR		
Holding Time	V/V Size	Time(sec)	V/V Size	Time(sec)	
	2" ~ 6"	60	2" ~ 6"	60	
	8" ~ 12"	120	8" & over	120	
	14" & over	300			

TITLE				
PNEUMATIC CONTROL HI-PERFORMANCE BUTTERFLY VALVE (MHF-100A-125S-SR)				
APR.	CHK.	DES.	SCALE	N / S
Oh J.r.	Oh J.r.	Calhoun	DATE	2020.03.23
200323	200323	200323	DWG No.	MCL-200323-A2

MCL (주)엠씨엘